

NAD-83(CORS96) epoch 2002.00  
INSPCS West Zone

15.564 Acres  
Andres Enterprises, Inc.  
Document #2006023448  
Parcel #84-09-34-400-017.000-003  
Zoned A-1

# A.L.T.A./A.C.S.M. LAND TITLE SURVEY

## 35.013 ACRES, SECTION 34, T11N, R9W

### TERRE HAUTE, IN 47802

**LEGEND**

○ EXISTING IRON PIN	— X — R/W FENCE LINE
● SET 5/8" REBAR AND CAP	— SAN — SANITARY SEWER
⊕ UTILITY VALVE	— FM — SANITARY FORCE MAIN
⊗ LIGHT POLE	— G — GAS LINE
⊙ FIRE HYDRANT	— UE — ELECTRIC LINE
⊕ UTILITY POLE	— OU — OVERHEAD UTILITY LINE
⊙ SANITARY MANHOLE	— FO — FIBER OPTIC LINE
● PINE TREE	— W — WATER MAIN
⊙ SIGN	
□ UTILITY BOX	

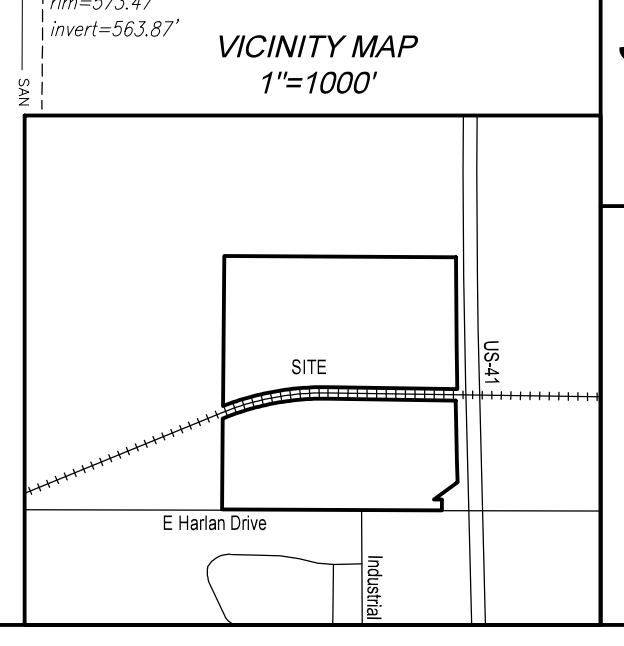
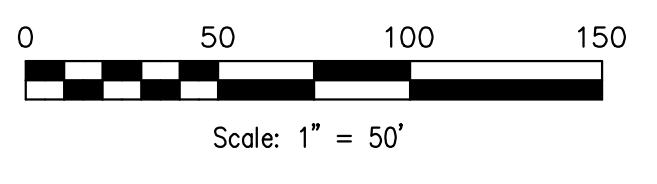

**WEBSTER LAND SURVEYING, L.L.C.**  
*Surveying the Tri-State Area*  
 2874 Presidential Drive Hebron, KY 41048  
 brent@nkylandsurveyor.com 859.760.7794

PROJECT NO.	20150002
DATE	February 8, 2015
SCALE	1" = 50'
DRAWING	CESD\LOVES-TERRE-HAUTE\DWG\TAL\LOVES-TERRE-HAUTE-2015.DWG
<b>PAGE 2 OF 3</b>	